

## Type NS-SSC-400 Stackable Storage Container

The type NS-SSC-400 Stackable Storage Container has been designed for a heavy load capacity suitable for all manufacturing and construction sites. This versatile container may be moved by crane, forklift or hand pallet truck. Forklift pockets allow four way entry with the stackable crane lug corners allowing the container to be stacked up to 4 high. The container may be emptied by forklift with rotating carriage or crane.

All type NS-SSC containers have a Safe Working Load of 2000kg and range in size from 0.4 – 1.2 cubic metre capacities. These containers have corner drain holes and are available in either enamel painted over primed steel or H.D. Galvanised finish.

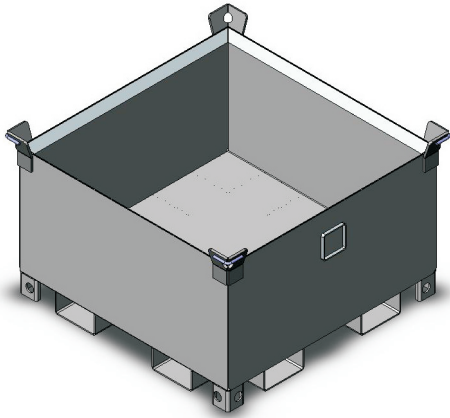

(Type NS-SSC 800 standard model shown)  
Refer 'NS-SSC\_W\_Sales' Product Specification Sheet for Wheels option.

### SPECIFICATIONS:

- Pocket Size 210 x 95mm
- Pocket Centres 540mm
- Safe Working Load (SWL) 2000kg
- Unit Weight – refer Table
- Volume Capacity – refer Table
- HCG 600mm
- VCG – refer Table

### OPTIONS:

- Wheels (non stackable), Lid
- No Drain Holes

